

DIE FESTUNG ROTHENBERG -
DER FESTUNGSBAU IM 18. JAHRHUNDERT,
MASSNAHMEN DER ERHALTUNG
UND MÖGLICHKEITEN DER KONSERVIERUNG

Inaugural-Dissertation,
in der Fakultät für
Geschichts- und Geowissenschaften
der Otto-Friedrich-Universität Bamberg

Institut für Archäologie, Bauforschung und Denkmalpflege,
Restaurierungswissenschaft in der Baudenkmalpflege

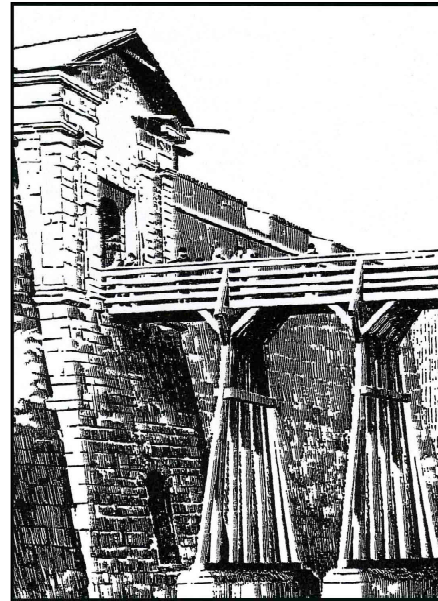

Band 3 / 6 Sammlung der Pläne

vorgelegt von Sven Thole Dipl. Ing. (FH) aus Erlangen
Bamberg, den 19.07.2006

Tag der mündlichen Prüfung: 05.02.2007

Dekan: Universitätsprofessor Prof. Dr. Mark Häberlein

Erstgutachter: Universitätsprofessor Prof. Dr. Ing. Rainer Drewello

Zweitgutachter: Universitätsprofessor Prof. Dr. Ing. Manfred Schuller

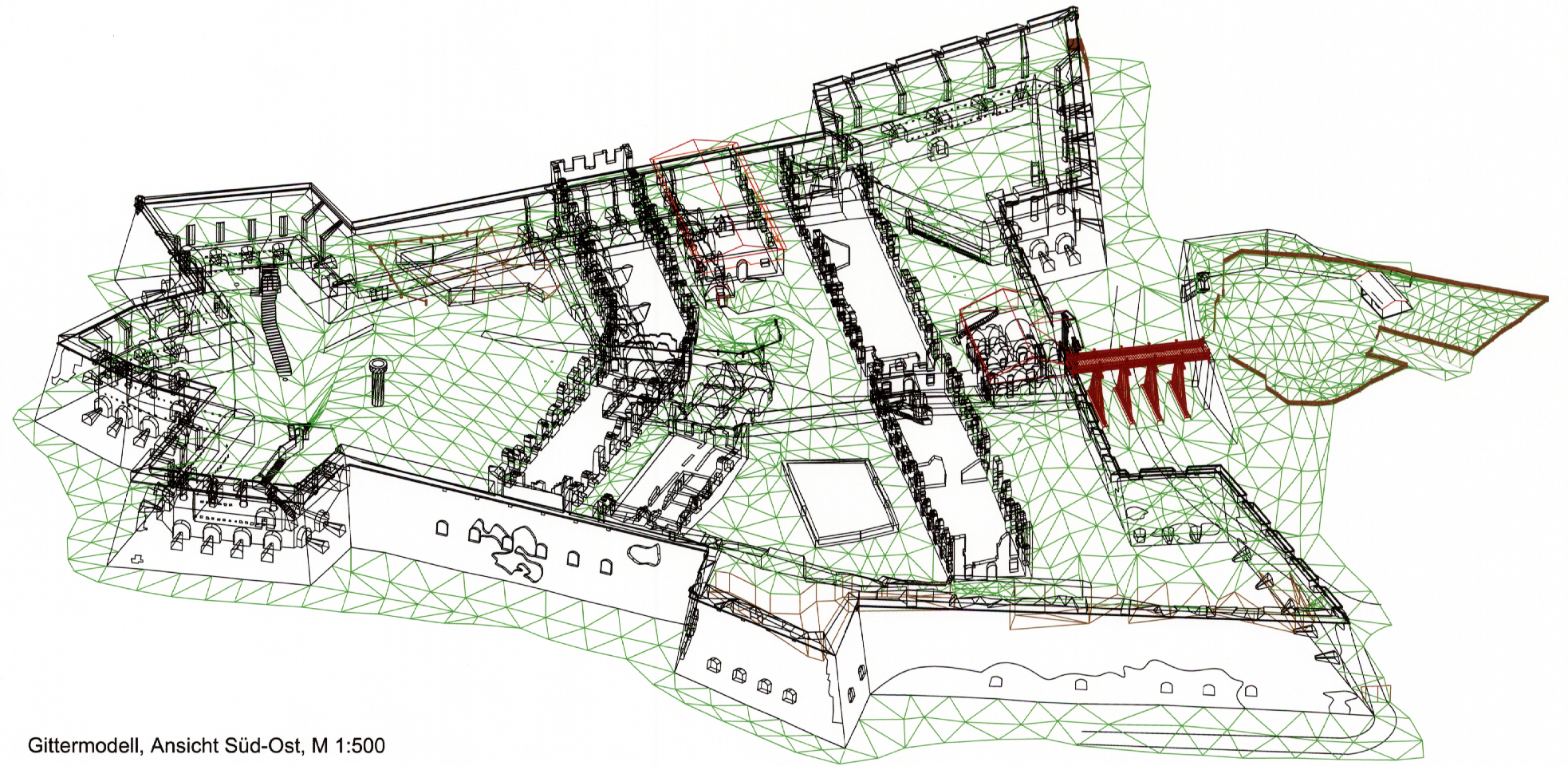

Gittermodell, Ansicht Süd-Ost, M 1:500

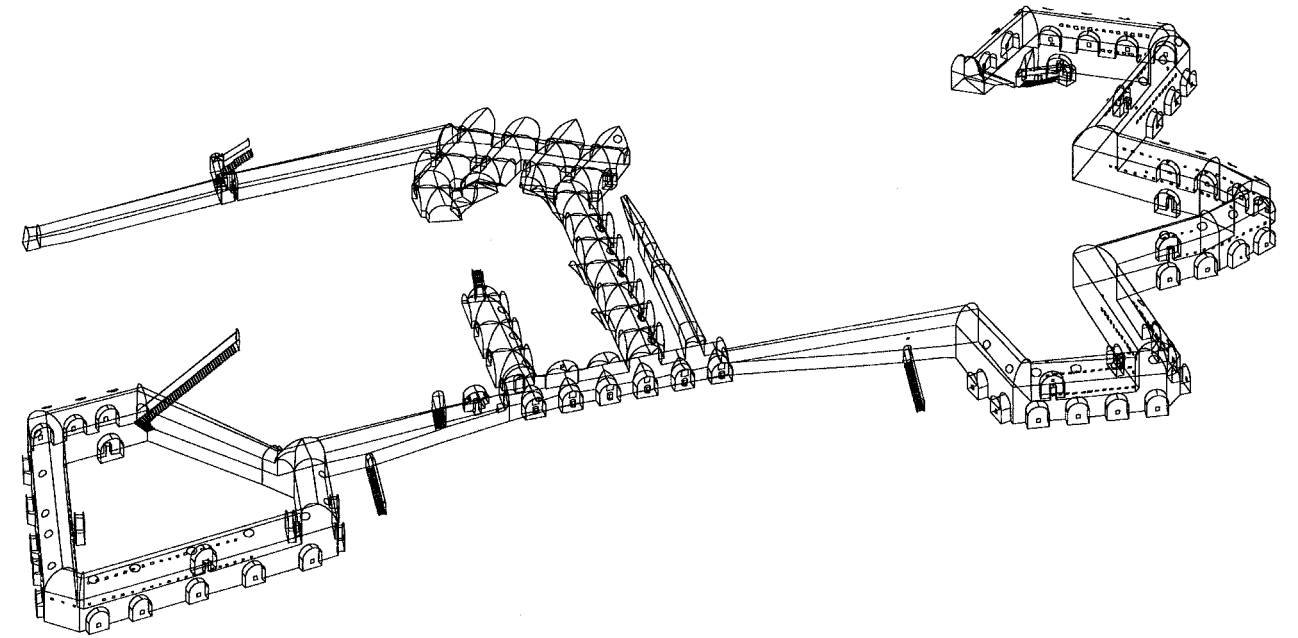

Gittermodell Kasematten, M 1:500

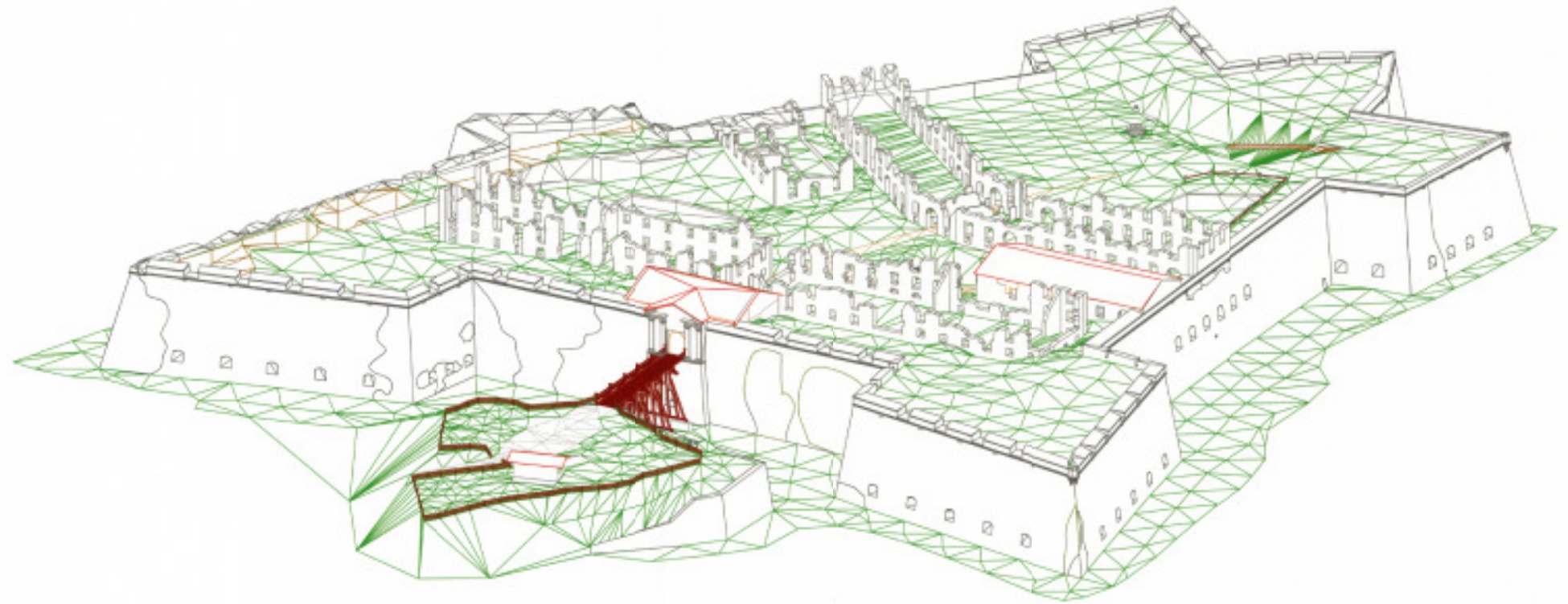

Flächenmodell, Ansicht Nord, M 1:500

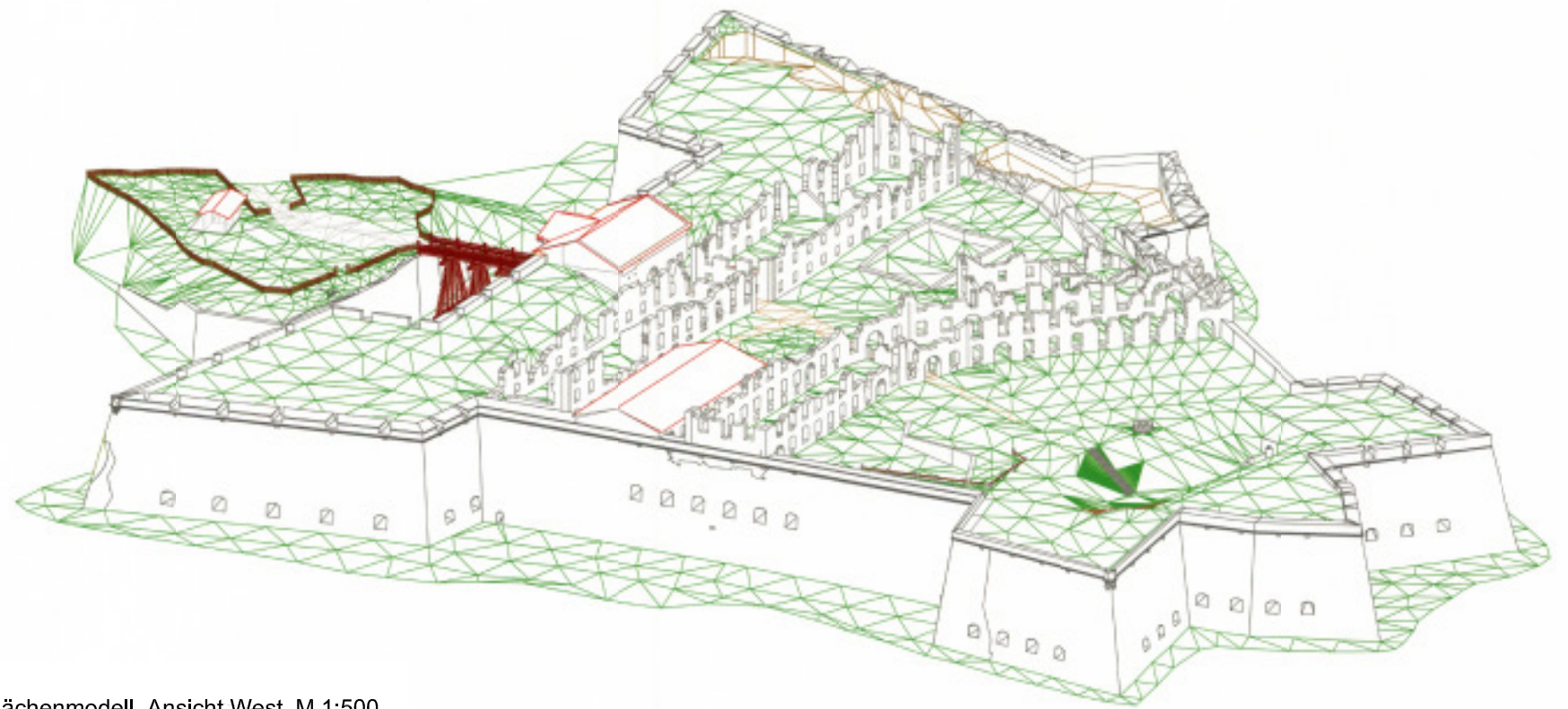

Flächenmodell, Ansicht West, M 1:500

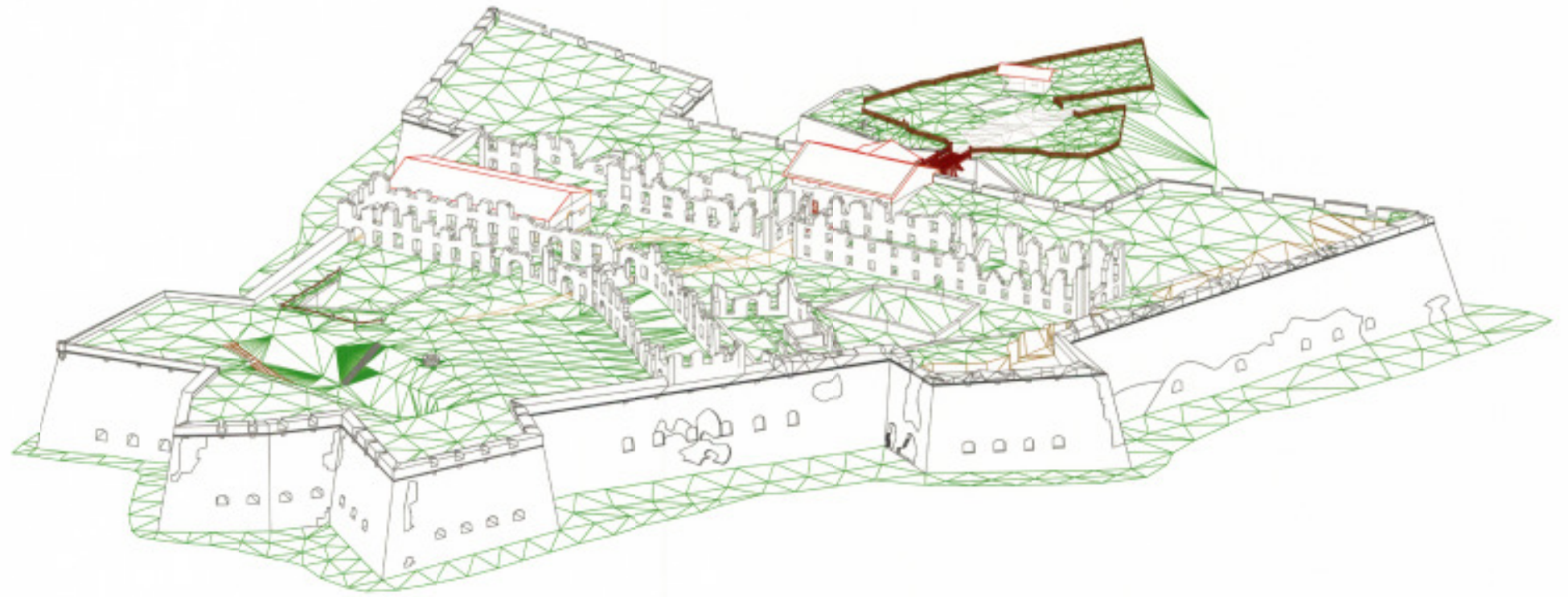

Flächenmodell, Ansicht Süd, M 1:500

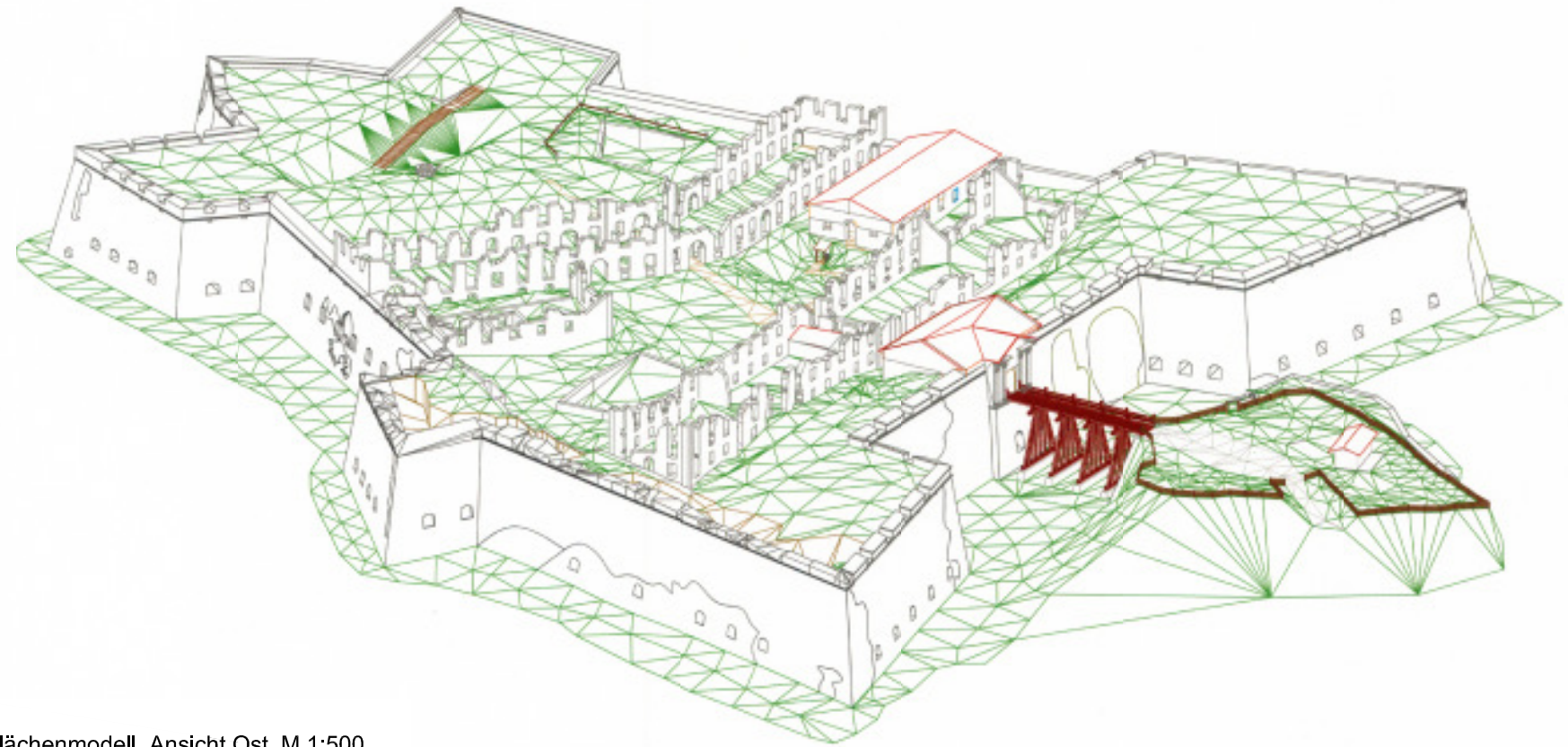

Flächenmodell, Ansicht Ost, M 1:500

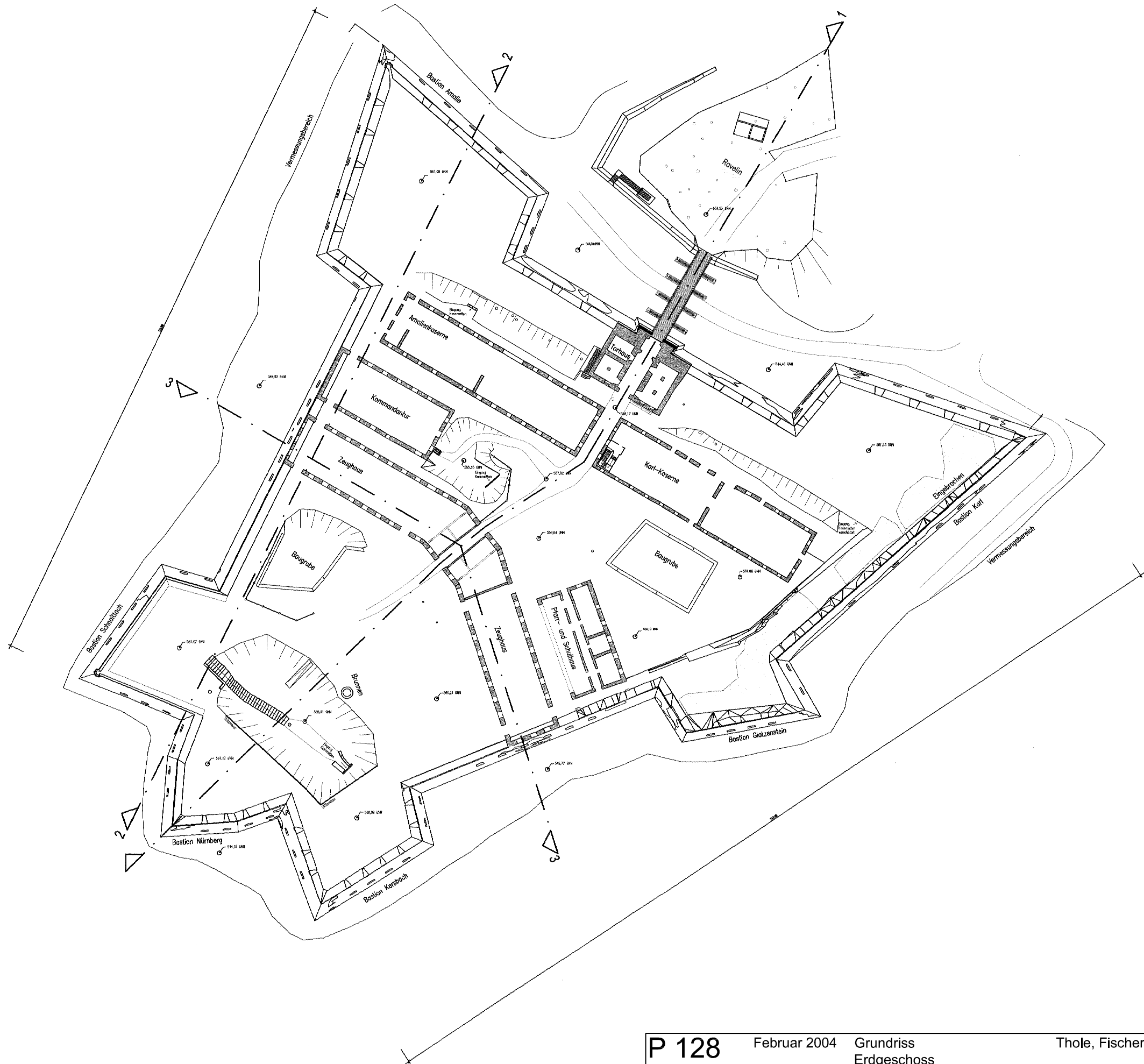

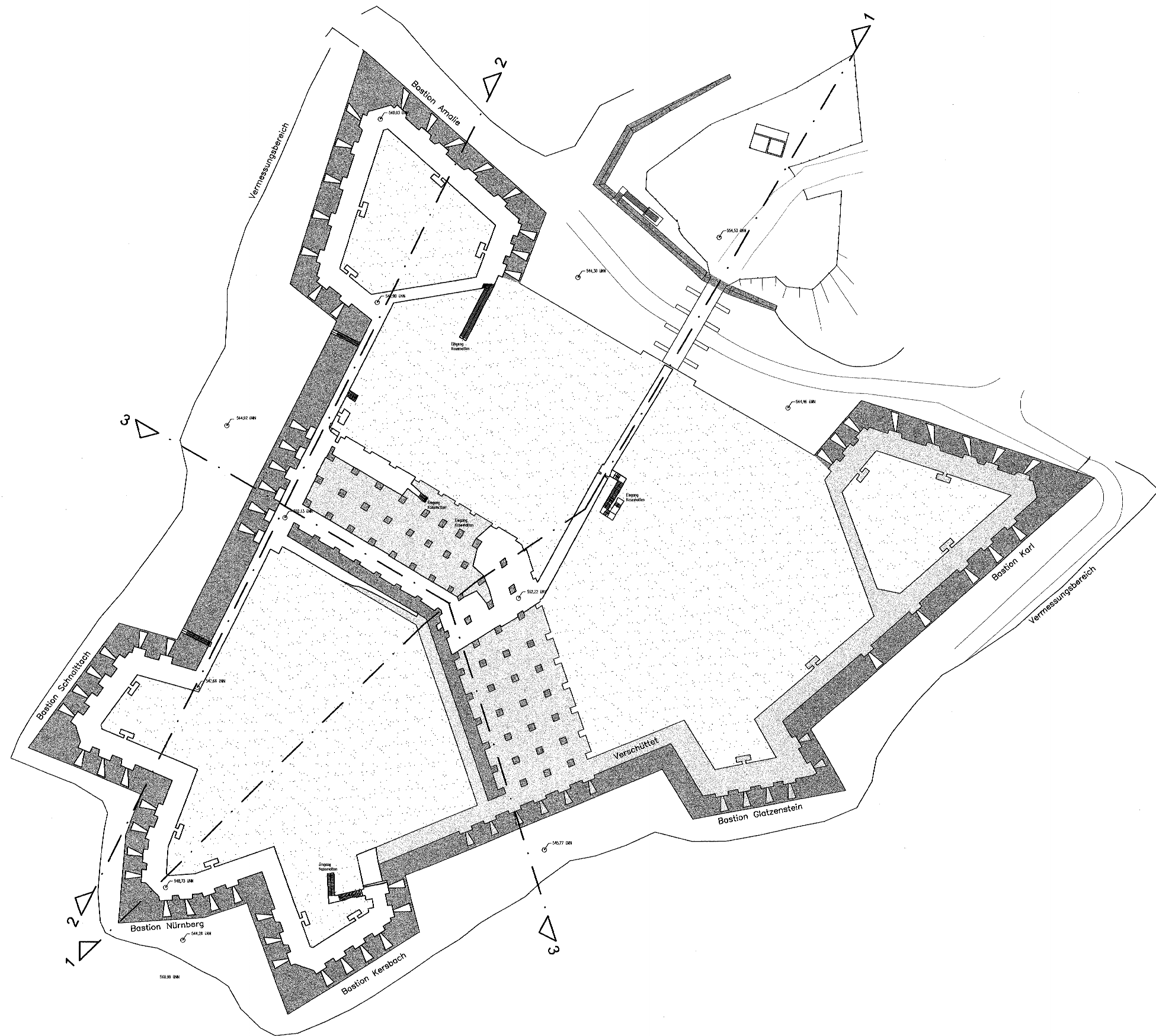

Grundriss Kasematten, M 1:500

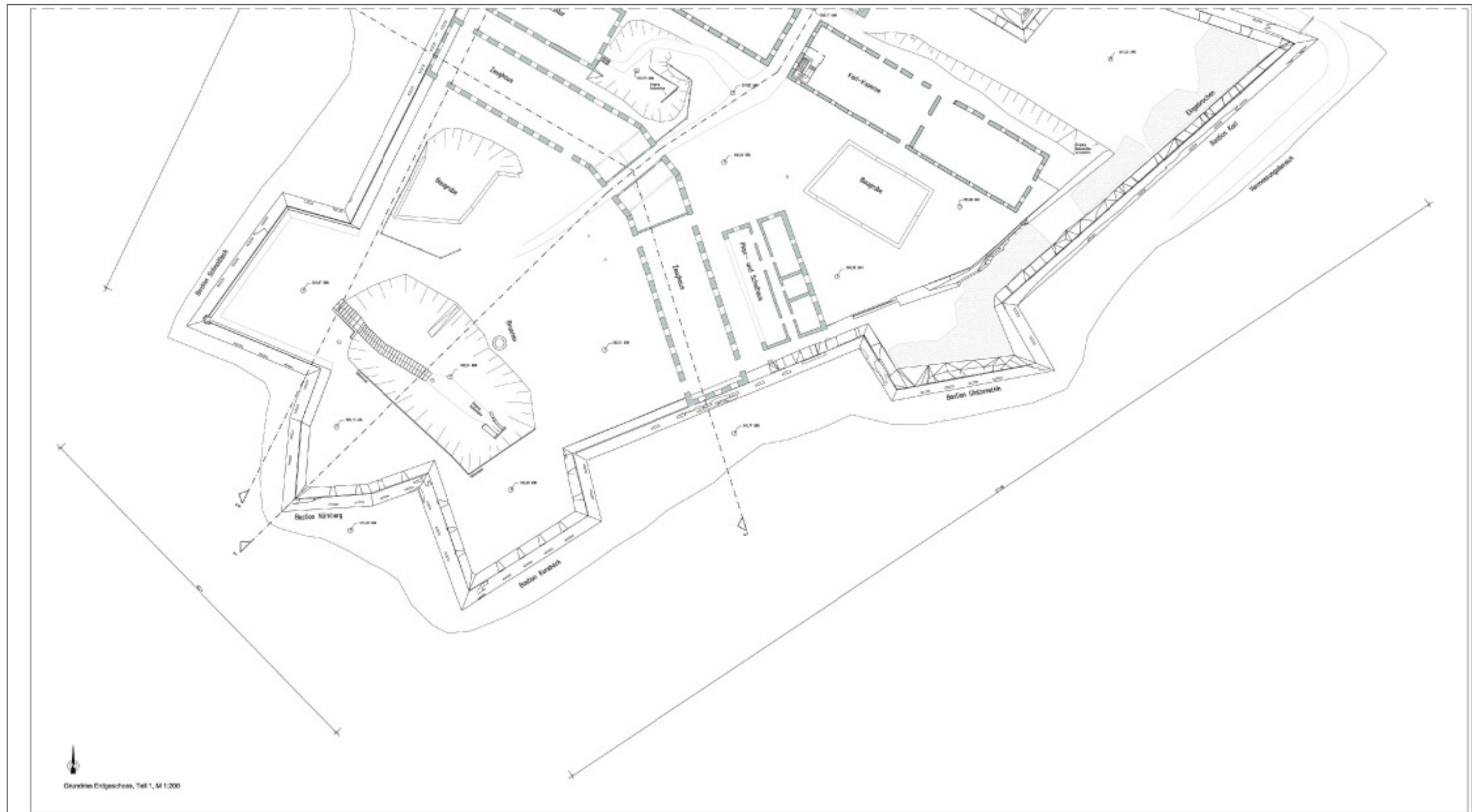

Grundriss Erdgeschoss, Teil 1, M 1:200

Grundriss Erdgeschoss, Teil 2, M 1:200



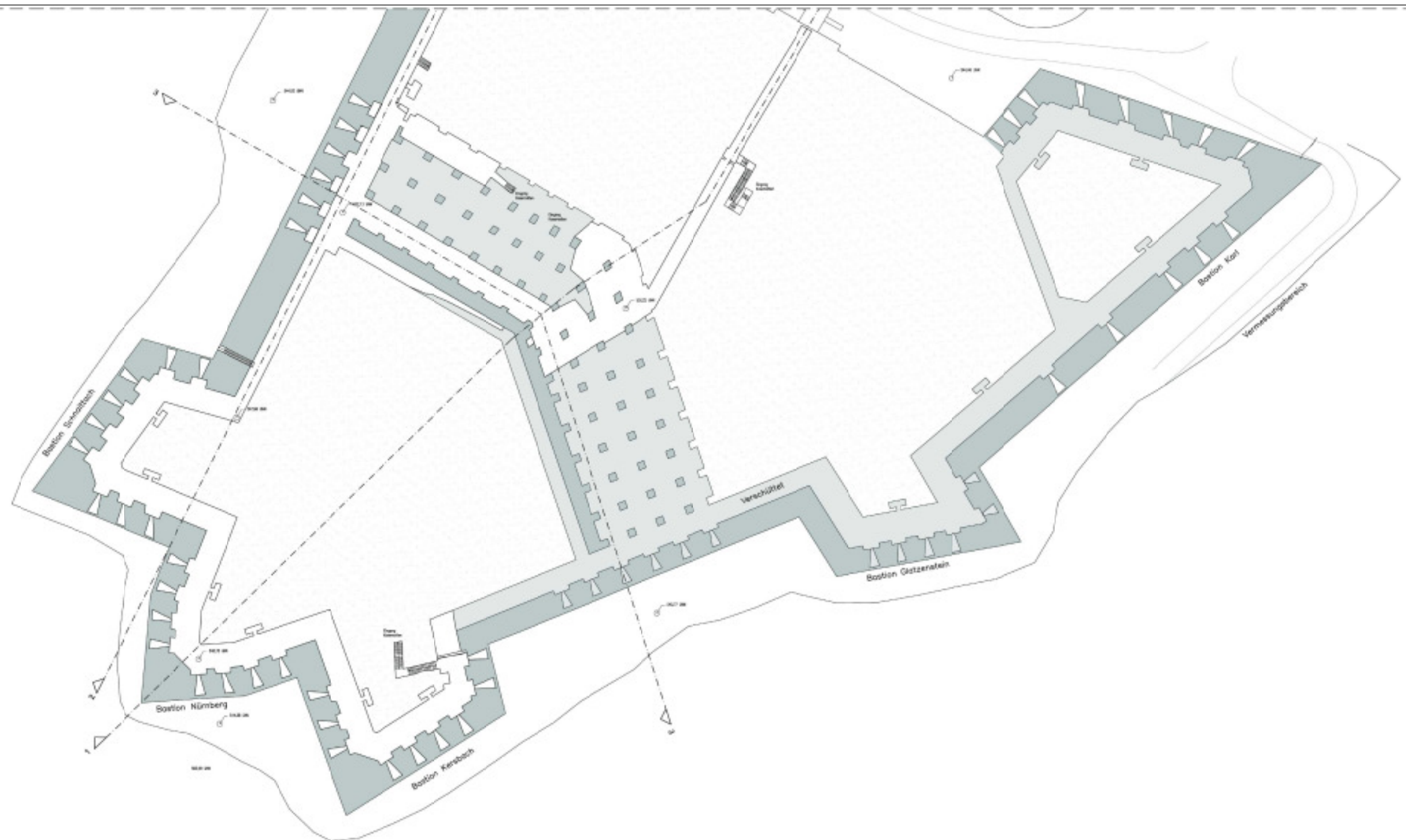

Grundriss Kasematten Teil 1, M 1:200



Grundriss Kasematten, Teil 2, M 1:200

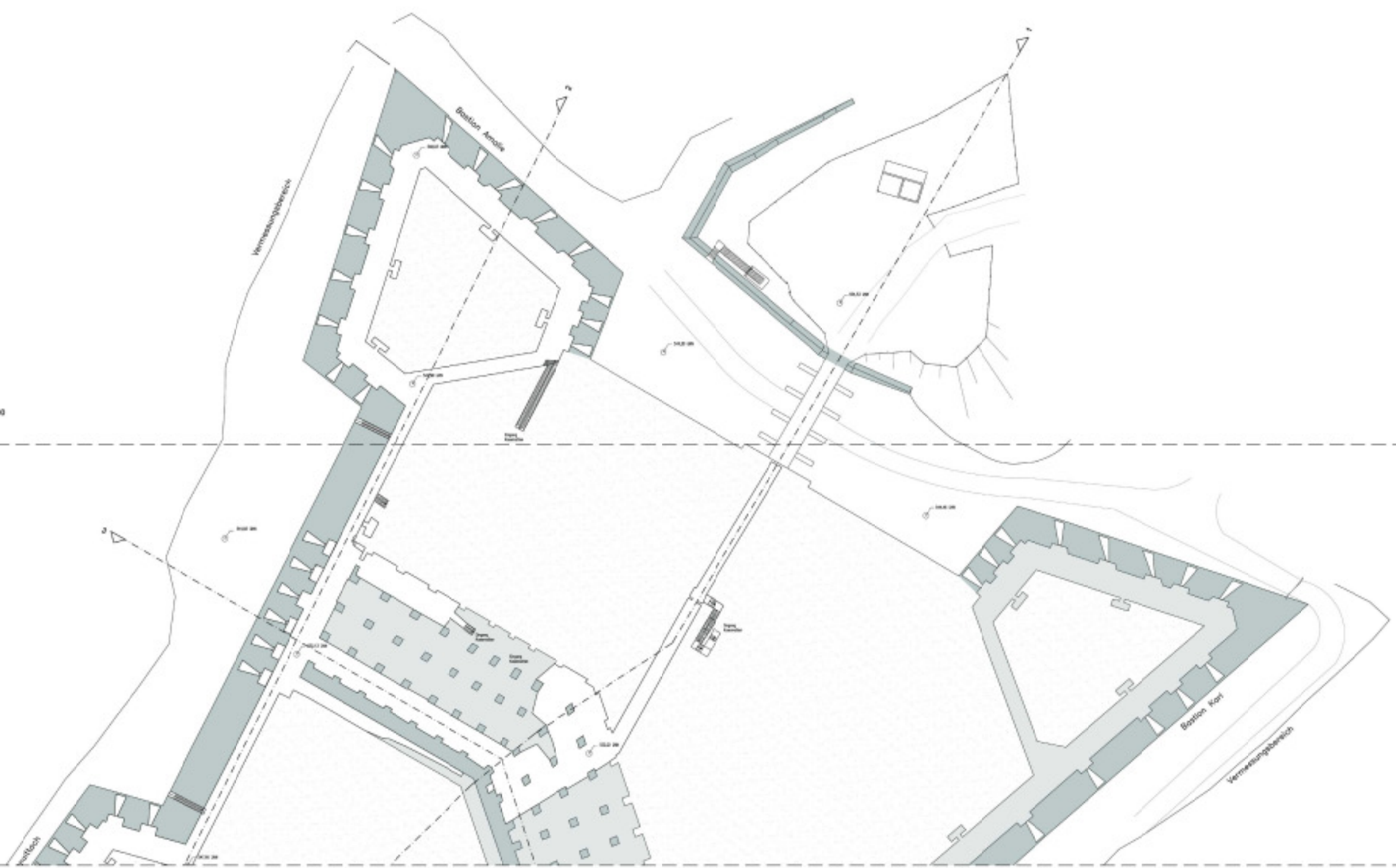

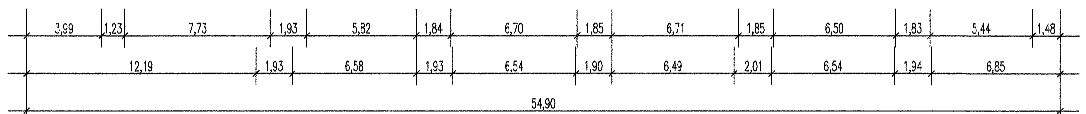
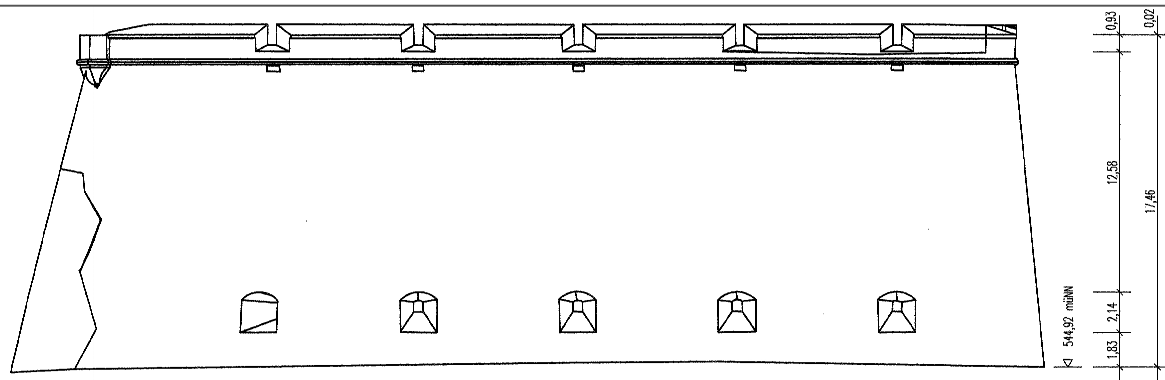

Ansicht 1
Bastion Amalie
Westseite

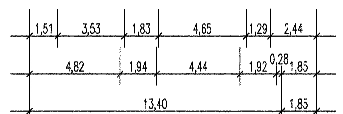
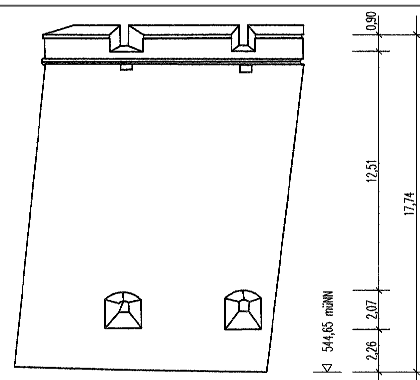

Ansicht 2
Bastion Amalie
Südseite

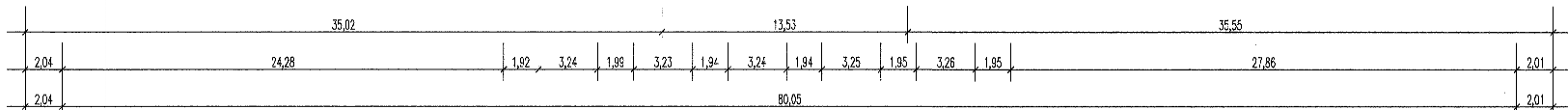
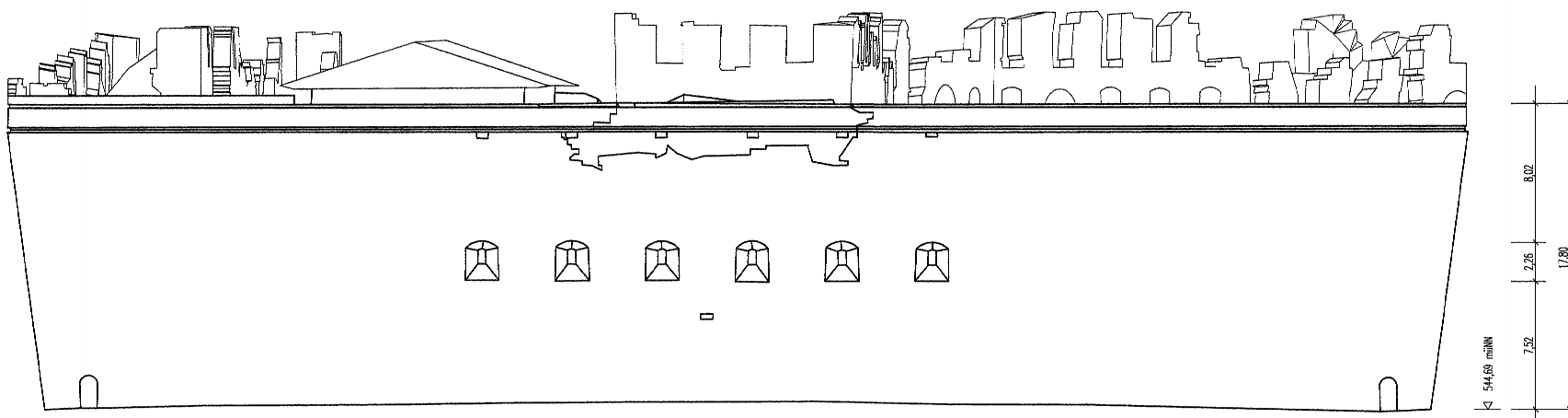

Ansicht 3
Courtine mit Zeughaus
und Kommandantur

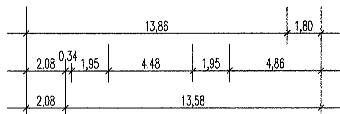
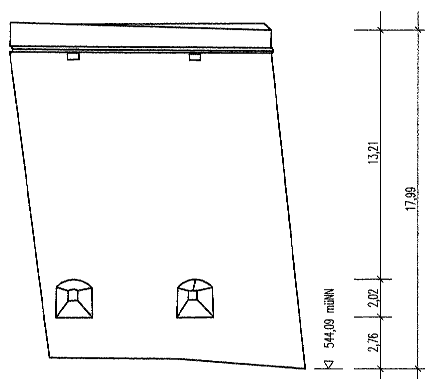

Ansicht 4
Bastion Schnaittach
Nordseite

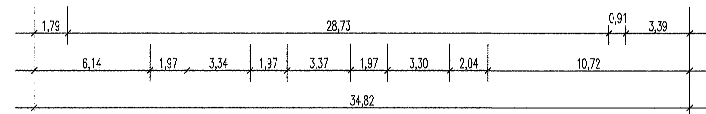
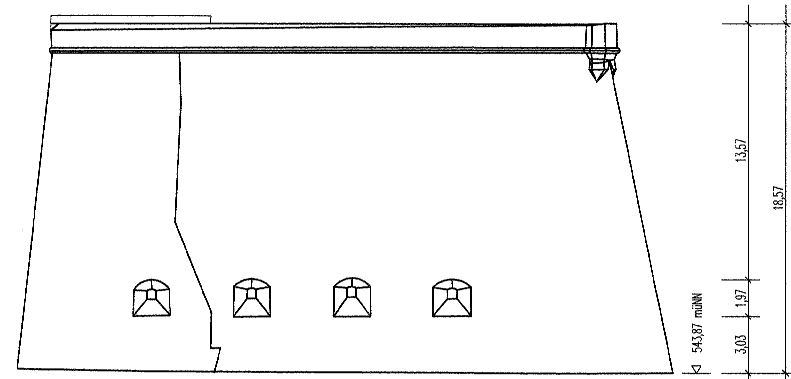

Ansicht 5
Bastion Schnaittach
Westseite

Abwicklung 1 - 5
M 1:200

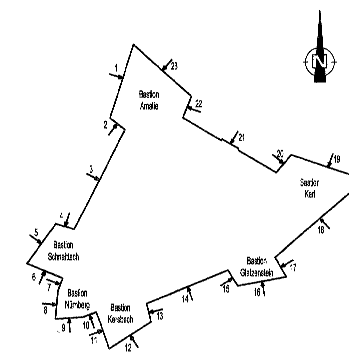

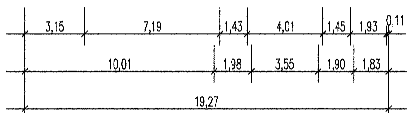
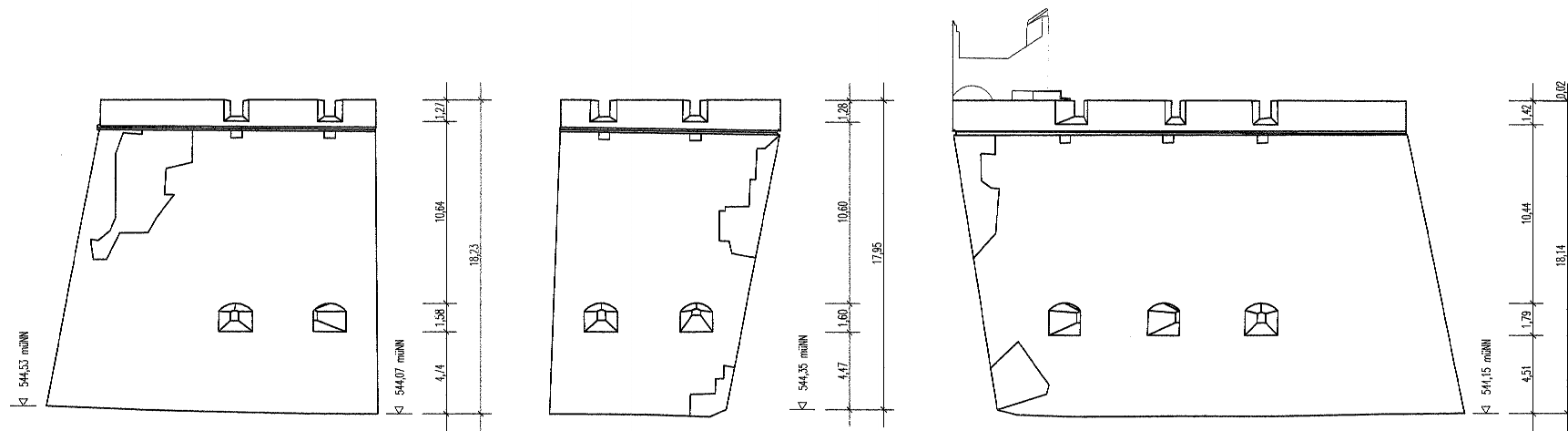

Ansicht 6
Bastion Nürnberg
Südostseite

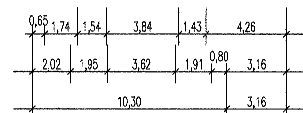

Ansicht 7
Bastion Nürnberg
Ostseite

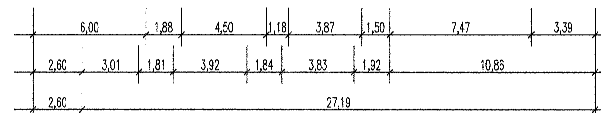

Ansicht 8
Bastion Kersbach
Westseite

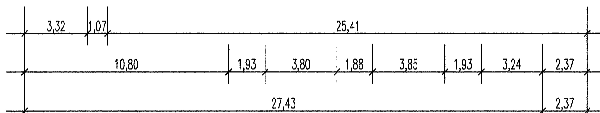
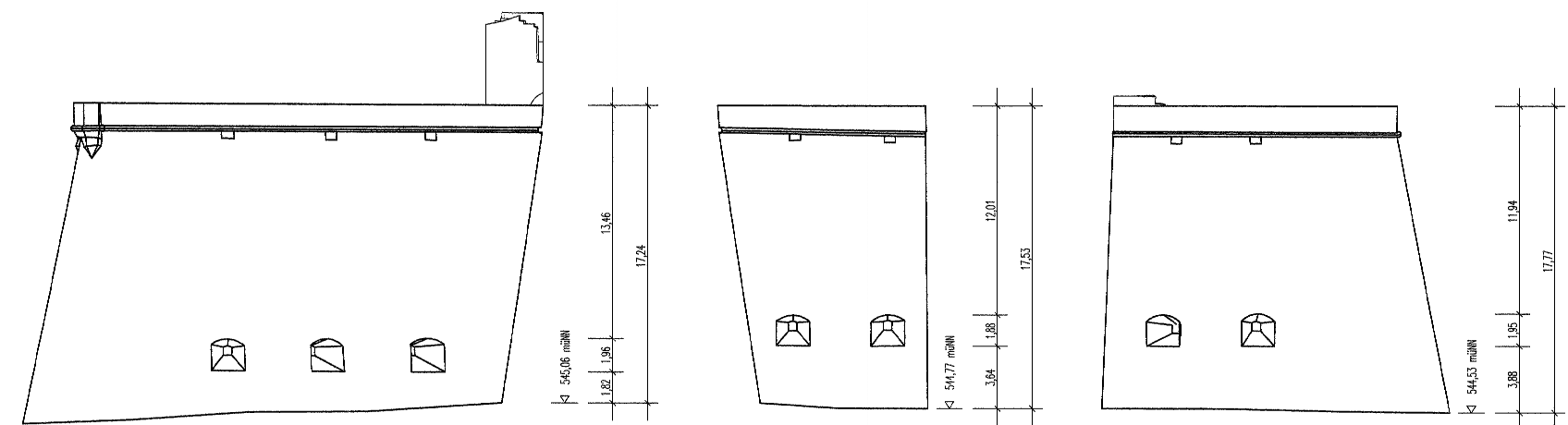

Ansicht 9
Bastion Schnaittach
Südseite

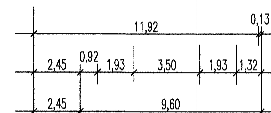

Ansicht 10
Bastion Nürnberg
Südseite

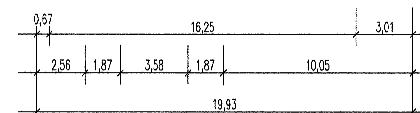

Ansicht 11
Bastion Nürnberg
Südwestseite

Abwicklung 6 - 11
M 1:200

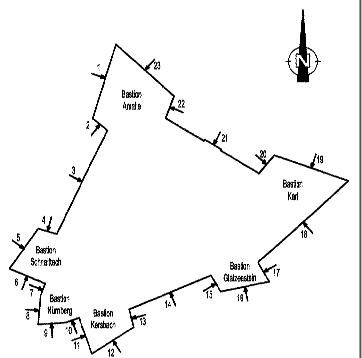

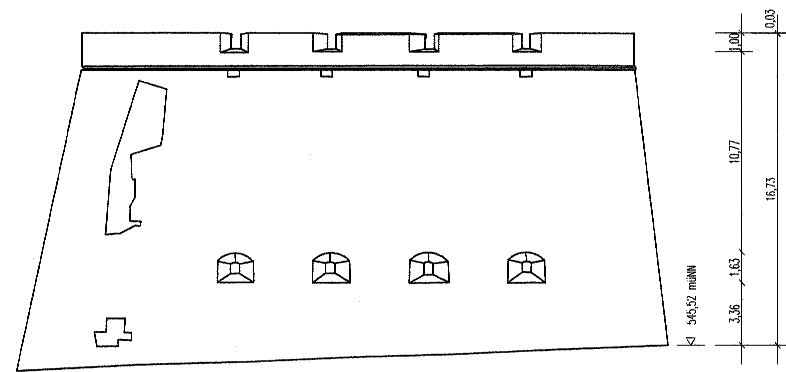

Ansicht 12
Bastion Kersbach
Südseite

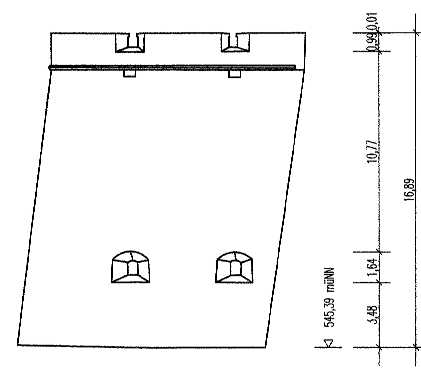

Ansicht 13
Bastion Kersbach
Ostseite

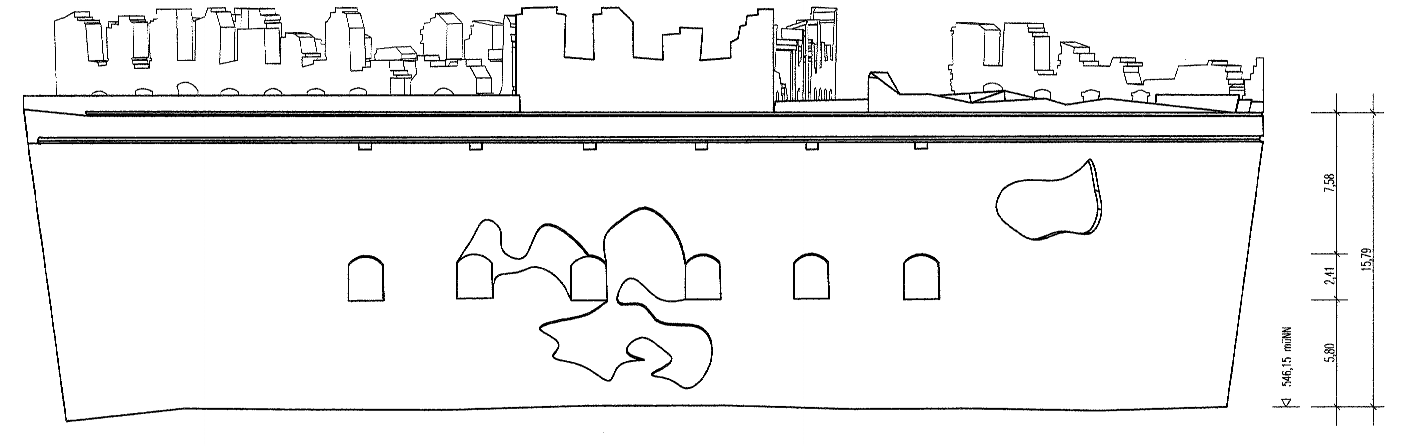

Ansicht 14
Courtine mit Zeughaus
und Ingenieurhaus

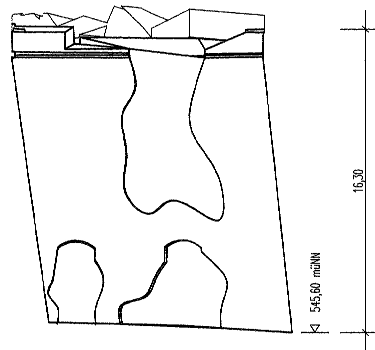

Ansicht 15
Bastion Glatzenstein
Westseite

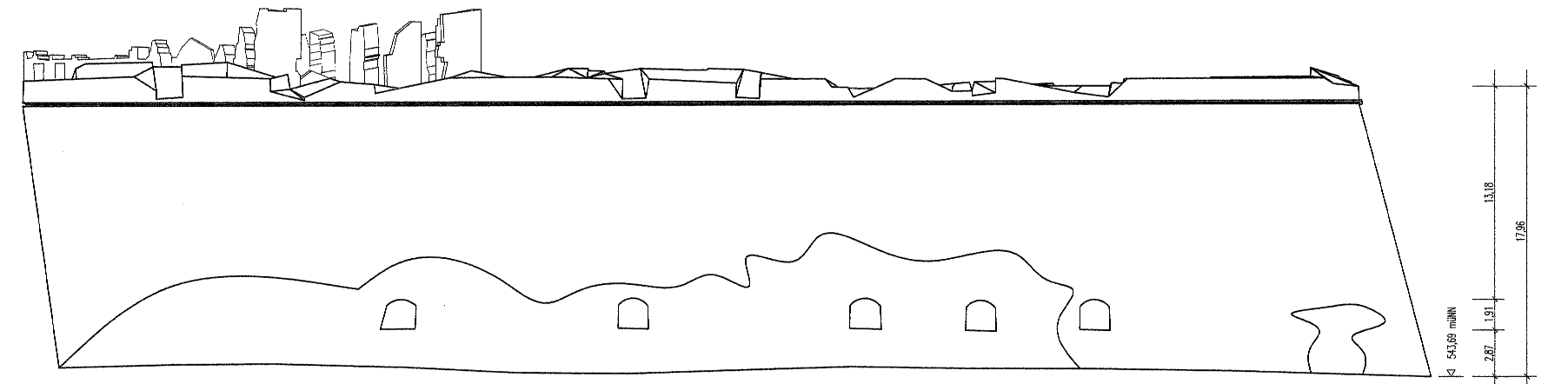

Ansicht 18
Bastion Karl
Südostseite

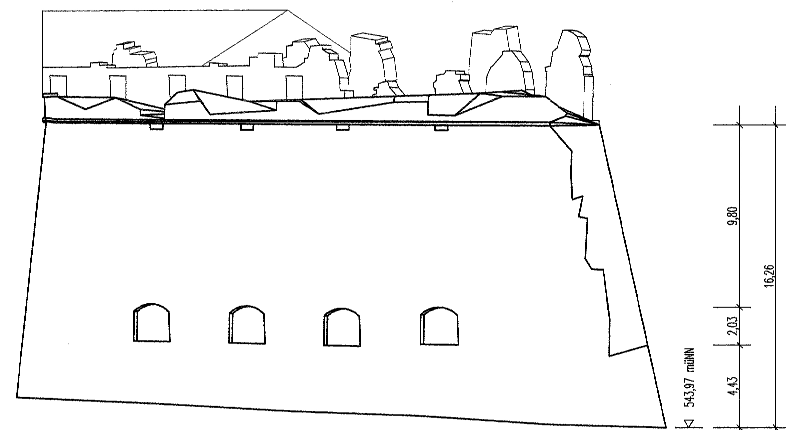

Ansicht 16
Bastion Glatzenstein
Südseite

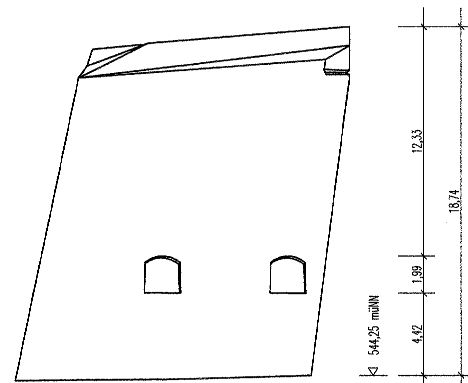

Ansicht 17
Bastion Glatzenstein
Ostseite

Abwicklung 12 - 18
M 1:200

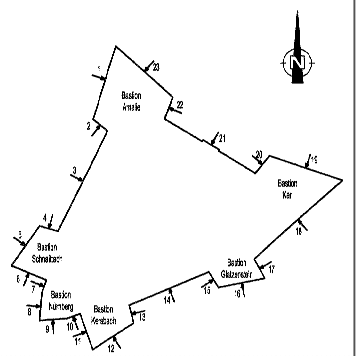

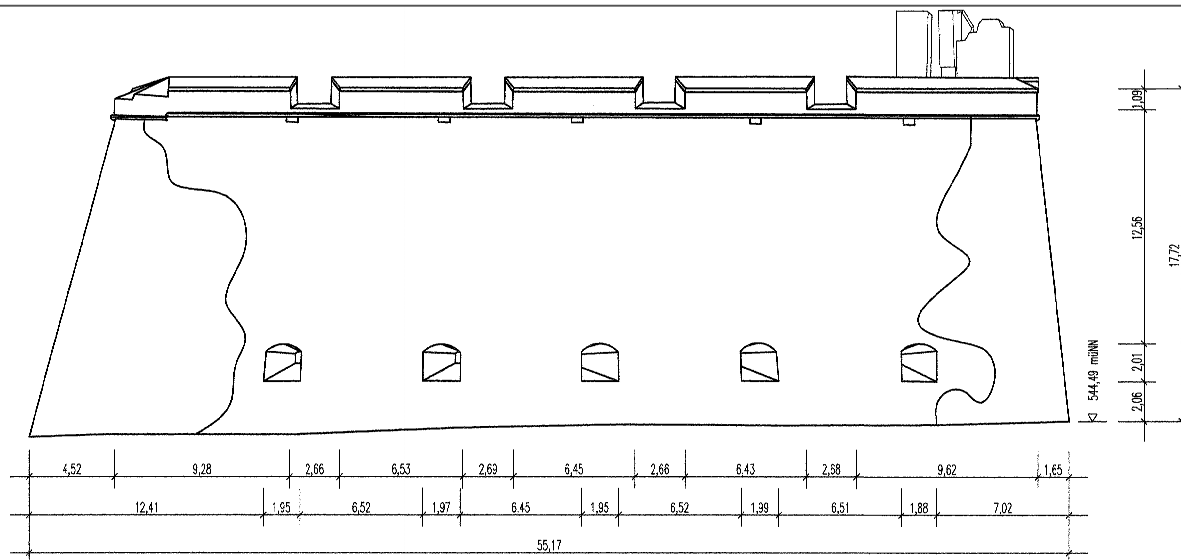

Ansicht 19
Bastion Karl

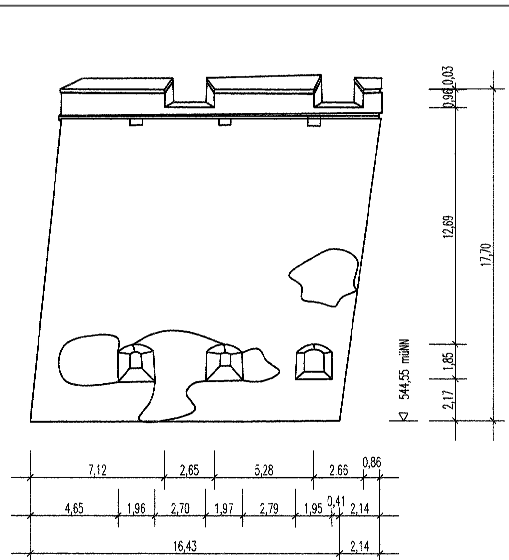

Ansicht 20
Bastion Karl

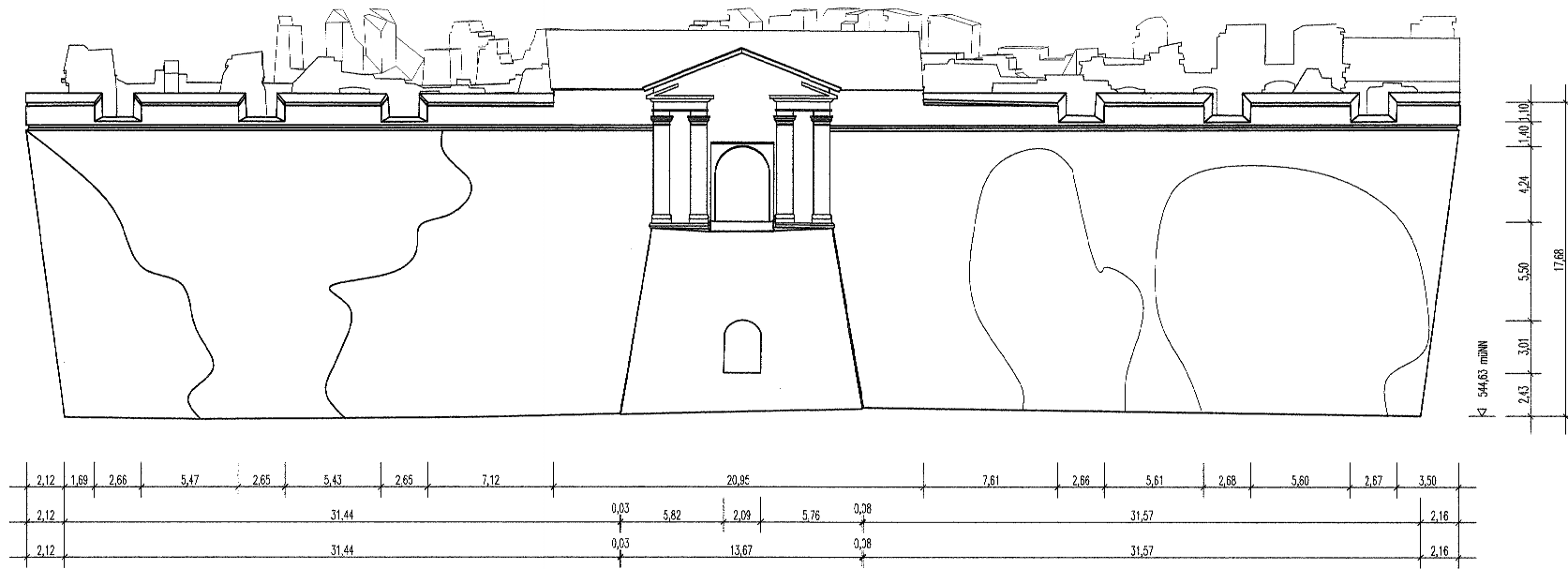

Ansicht 21
Courtine mit Torhaus
Nordostseite

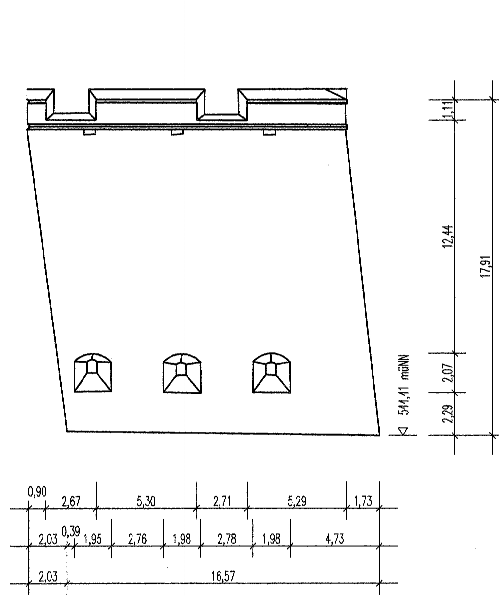

Ansicht 22
Bastion Amalie
Ostseite

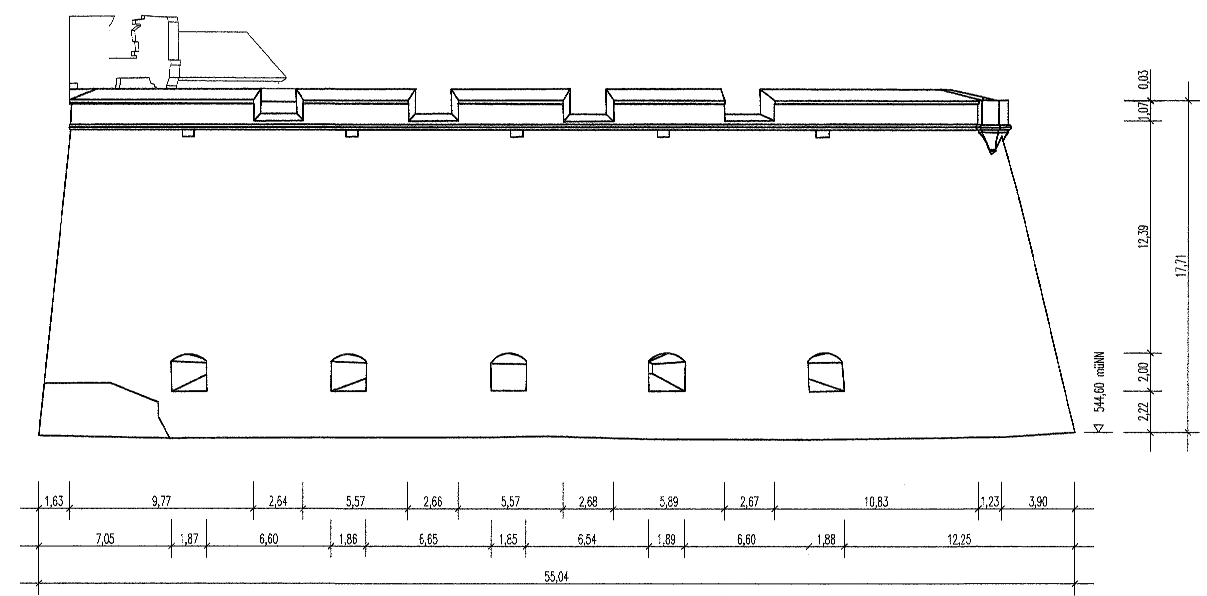

Ansicht 23
Bastion Amalie
Nordseite

Abwicklung 19 - 23
M 1:200

